

# HEAT EXCHANGERS

## Custom Shell and Tube

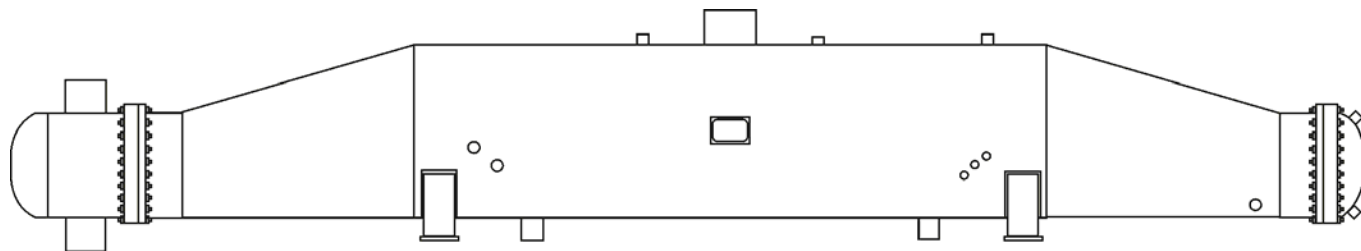

Suitable for Ammonia

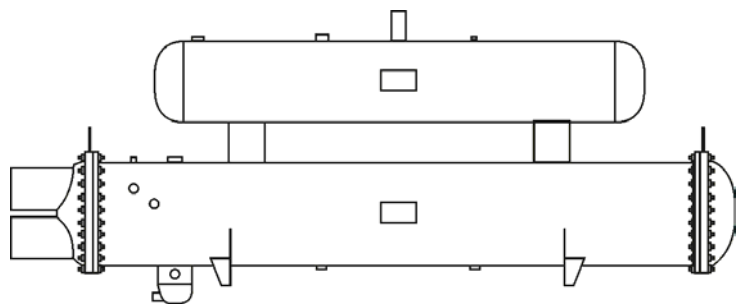
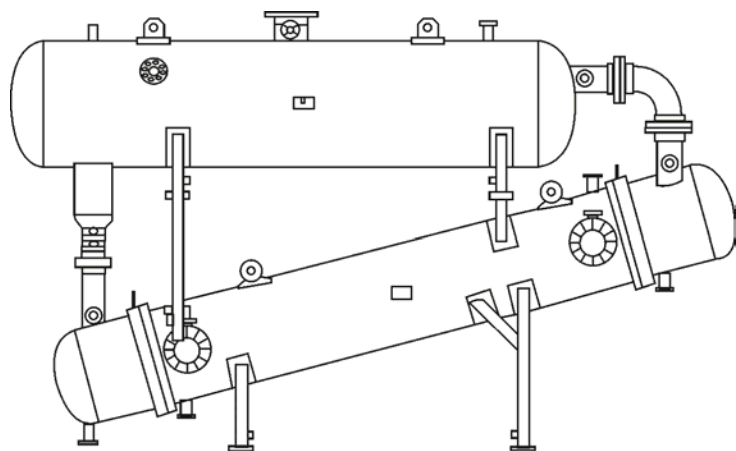

### Specifications:

- **Straight tube or U-tube** construction with removable heads; heads designed with integral baffles to provide proper fluid velocity with minimum pressure drop
- **Codes:** Construction to Section VIII of the ASME Code, PED, TEMA C, B & R and API-660. Other International codes available
- **Working Pressures:**
  - Shell side: 1000 PSI
  - Tube side: 1000 PSI
- **Materials:** Carbon Steel, Stainless Steel, Titanium, Monel, Hastalloy and Cupro-Nickel
- **Heads:** TEMA Type A, B, C, S & T (Floating heads)
- **Tube Sheets:** Carbon Steel, Stainless Steel, Titanium, Monel, Hastalloy and Cupro-Nickel
- **Sizes:**
  - Maximum Tube Length - 40 feet
  - Maximum Overall Length - 50 feet
  - Maximum Diameter - 96 inches
  - Maximum Weight - 30 tons
  - Maximum Height - 20 feet
- **Connections:** ANSI Weld neck or slip-on flanges, FPT or MPT threaded, ODS, Socket Weld or pipe stubs
- **Pressure Testing:** Pneumatically tested to ensure cleanliness & dryness
- **Inspection:** Radiographic, Ultrasonic, Mag Particle & Dye Penetrant
- **Units** are custom designed according to your thermal duty and your requirements

